

VIEW A-A

VIEW B-B

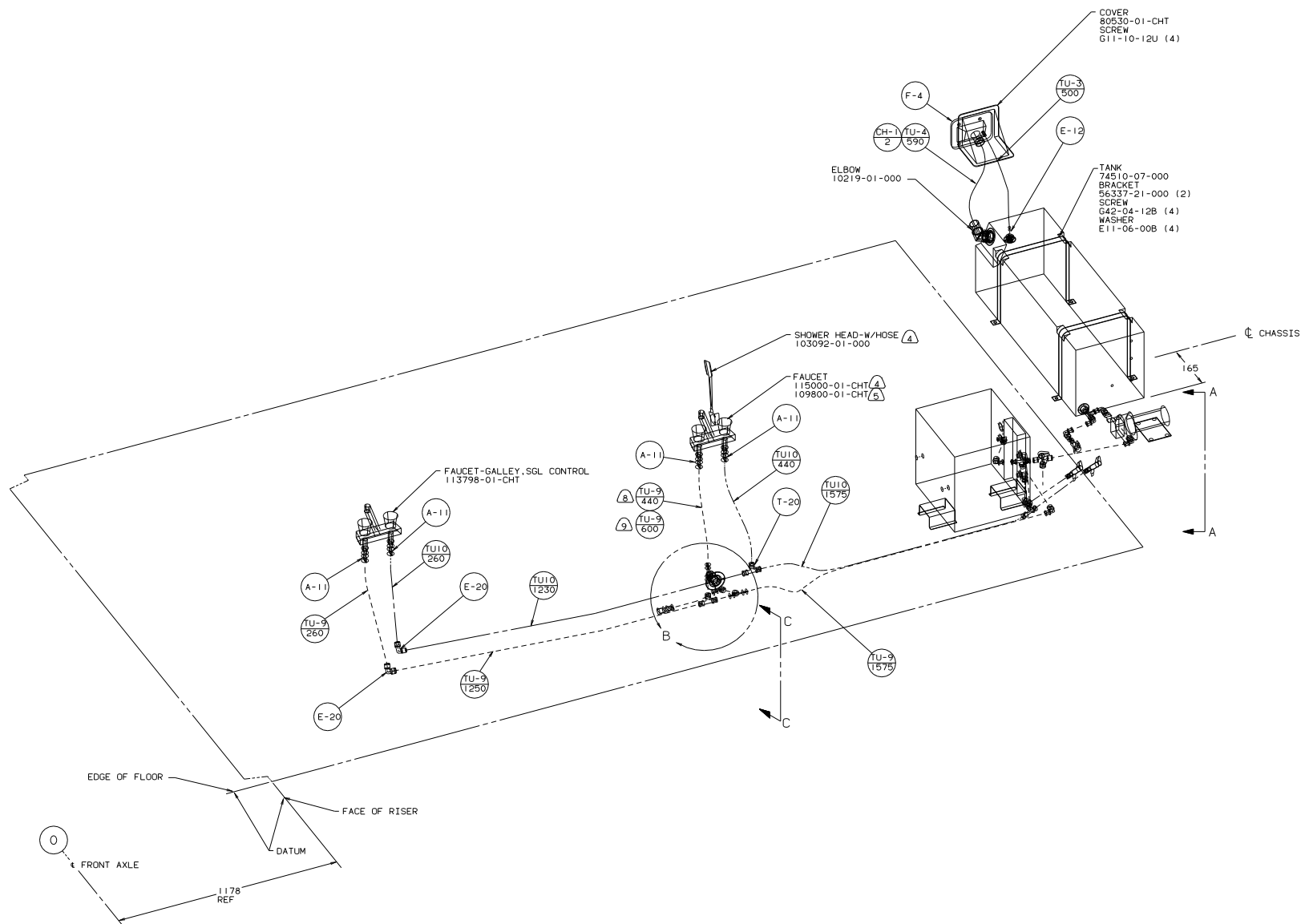

- (7) USE WITHOUT EXTERIOR SHOWER.
- (6) USE WITH EXTERIOR SHOWER ONLY.
- (5) USE WITHOUT SHOWER SUMP SYSTEM.
- (4) USE WITH SHOWER SUMP SYSTEM.

3. ALL TUBING TO BE SECURED AT 1200 INTERVALS MAXIMUM WITH CLAMP 10495-01-000 OR CLIP 91951-01-000 AND SCREW G67-10-12B.
2. TUBING TO BE INSTALLED WITH SUFFICIENT SLOPE TO PROVIDE DRAINAGE TO NEAREST VALVE.
1. PLASTIC FITTINGS TO BE SEALED WITH SEALANT 84456-01-000

- (1) USE ON 98 MODELS.
- (10) USE ON 97 MODELS.
- (9) USE WITH WIE EXPORT PREP PACKAGE.
- (8) USE WITHOUT W.I.E. EXPORT PREP PACKAGE.

FOR WATER CALLOUTS SEE DWG NO. 116230-01-000

LEGEND	
HOT	—————
COLD

WINNERAGO 96 221RC		
QTY	UNSPECIFIED TOLERANCES ARE:	MATERIAL
CHRP	WHOLE DIM (IN)	1/8"
F/F	ONE-PLACE (IN.XI)	1/16"
M/E	TWO-PLACE (IN.XX)	1/32"
W/E	ANGLE	1/8"
CDR	THIRD ANGLE PROJECTION	
LANHT NO. 221RT6	TITLE: WATER SYSTEM INSTL	
DIA #	SCALE: NONE	30 NET SCALE DRAWING
ALL DIMENSIONS ARE IN MILLIMETERS	SHEET 1 OF 2	119075

